

185 nom. offsel
rom fundamental
s.o.p.

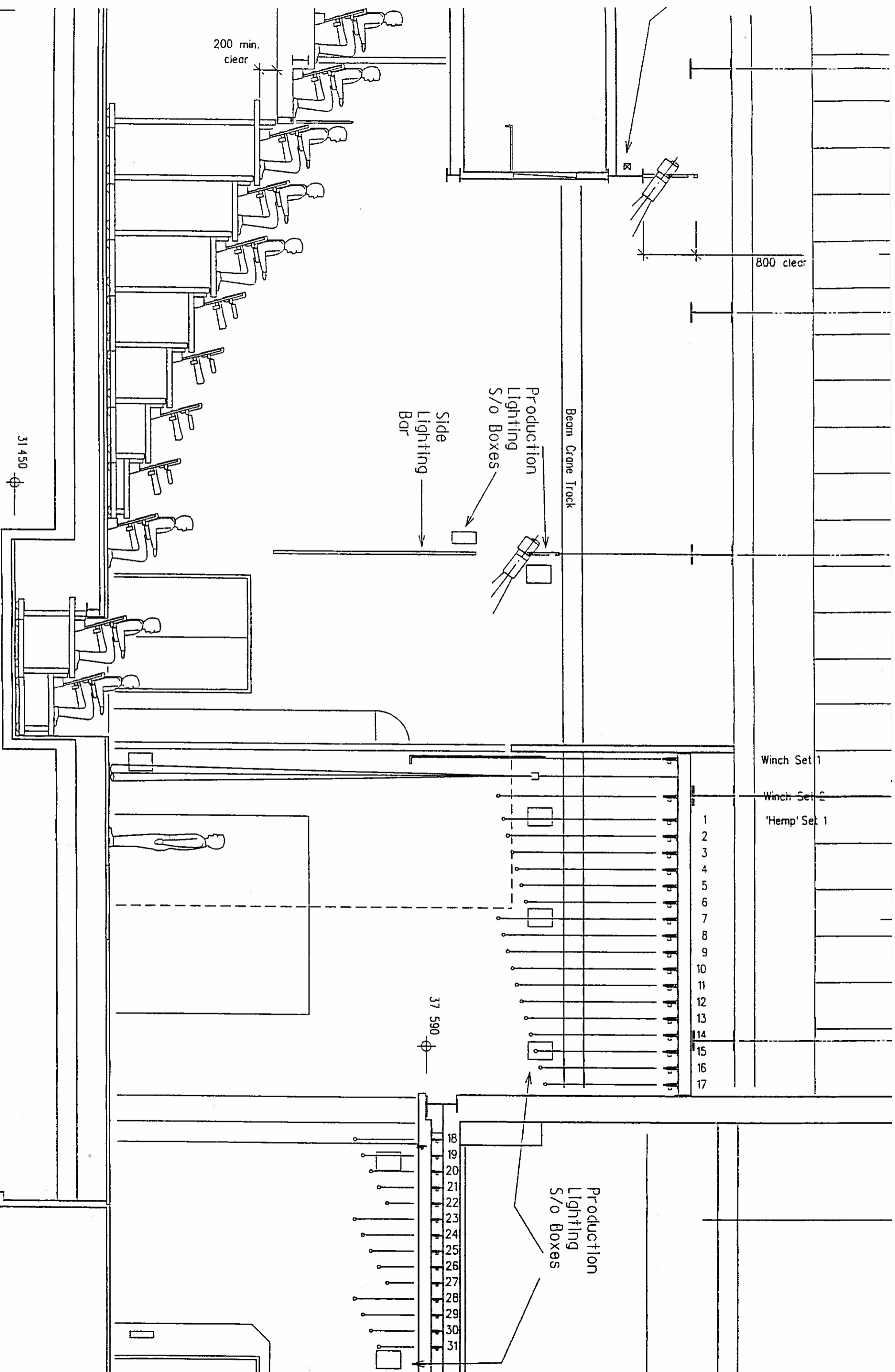

SCALE 1:50

LX4 Cyc – 6 x 12x7w RGBA LED battens Bar 22
121 - 126

Grid height 4.2m

LX3
4 x 18x7w
LED RGBA



Bar 14

Grid height 9m

5m

LX2
4 x 18x7w
LED RGBA



Bar 7

LX 1
6 x Selecon PL3
LED fresnels
RGBW
4 x 18x7w
LED RGBA



Proscenium

Side perch
4 x Lanta
Fireball LED
RGB
901-904

1 x Par 64
CP62
16

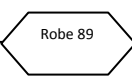
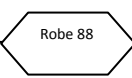

Side perch
4 x Lanta
Fireball LED
RGB
905-908

1 x Par 64
CP62
17

Advance
6 x Selecon PL3 LED
fresnels RGBW
2 x Robe DLS moving
head profiles

**The Electric Theatre
standard rig plan – not to
scale!**

Bridge
8 x Selecon
PL4 LED
profiles
RGBW



Bridge Patch Panel Red Phase	Channels 1 – 8 Independents 1 & 2 (PL4 LED's on BYPASS 3 & 5)
FoH Advance Bar Yellow Phase	Channels 9 – 14 Independents 3 & 4 (PL3 LED's on BYPASS 13,14)
FoH Side Booms Yellow Phase	Channels 15 – 18 Independent 3 / 5 (LANTA FIREBALLS)
On Stage LX1 Yellow Phase	Channels 19 – 24 Independent 4 (Repeated from advance) (PL3 LED's on bypass 23+24) + 22 for DMX Split
On Stage LX2 Blue Phase	Channels 25 – 30 Independent 6 (Chauvet LED's on bypass 25+26)
On Stage LX3 Blue Phase	Channels 37 – 40 (Repeated at rear of stage) (Chauvet LED's on bypass 25+26)
On Stage LX4 Blue Phase	Channels 31 – 36 (LED Battens on Bypass 39 + 40)
On Floor Up Stage L & R Red Phase	Channels 41 – 44 GP 13 amp socket with circuit breaker Independent 8 TP 13 amp socket
On Floor Down Stage L & R Red Phase	Channels 45 – 48 GP double 13 amp socket with circuit breaker Riggers Independent 7

The Electric Theatre Lighting Patch Panels

Electric Theatre LED HOT POWER AND CONTROL FOR HOUSE RIG

Bridge 8 x PL4 Profiles	Bypass 4 + 5 Assigned Ion channels 101-108
FoH Advance Bar 6 x PL3 Fresnels 2 x ROBE Movers 8 x LED Boom Pars	Independent 3 (Robe) + Bypass 13,14 Assigned Ion channels 201-206 Assigned Ion channels 801-802 Independent 5 Assigned Ion channels 901-908
LX1 6 x PL3 Fresnels 4 x Chauvet ColorQuad Pars	Bypass 23 + 24 (+22 for DMX split) Assigned Ion channels 301-306 Assigned Ion channels 501-504
LX2 4 x Chauvet ColorQuad Pars	Bypass 25 + 26 Assigned Ion channels 601-604
LX3 4 x Chauvet ColorQuad Pars	Bypass 25 + 26 Assigned Ion channels 701-704
CYC 6 x Chauvet ColorQuad Battens	Bypass 39 + 40 Assigned Ion channels 121-128

ION LED GROUP ASSIGNMENTS

GROUP

1	Bridge Profiles
2	Advance Fresnels
3	LX1 Fresnels
4	ALL BL Pars
5	LX1 Pars
6	LX2 Pars
7	LX3 Pars
8	Robe Movers x 2
9	LED Boom Pars
12	Cyc battens

ION ADVICE FOR COLOUR CHANGING

Select the light you want to colour, press 'Displays' – 'Colour Picker' on soft keys will bring up colour wheel or click on Lee / Rosco and choose specific colours.

Electric Theatre DMX Addressing DMX universe 1 out of desk into RING A

Hard wired dimmers – ch. 1 – 48 (see distribution above inc BYPASS)

Act Six x 3 USR - ch. 49 – 66

Unique Hazer (two channels) ch 67/68

Magnum 2000 smoke ch. 69

HOUSELIGHTS ch. 70 / (PL3 and PL4 8 bit / Robin DLS mode 1)

Channel	UNIT	DMX		Channel	UNIT	DMX
Bridge	Group 1			LX 1	Group 3	
101	Philips/Selecon PL4 Profile 1	71-79		301	Philips/Selecon PL3 Fresnel 7	255-266
102	PL4 2	80-88		302	PL3 8	267-278
103	PL4 3	89-97		303	PL3 9	279-290
104	PL4 4	98-106		304	PL3 10	291-302
105	PL4 5	107-115		305	PL3 11	303-314
106	PL4 6	116-124		306	PL3 12	315-326
107	PL4 7	125-133		LX 1	Group 5 (Group 4 all O/H pars)	
108	PL4 8	134-142		501	Chauvet Color-Dash Par Quad 18 1	215-224
				502	Chauvet Par 2	225-234
Advance	Group 2			503	Chauvet Par 3	235-244
201	Philips Selecon Fresnel PL3 1	143-154		504	Chauvet Par 4	245-254
202	PL3 2	155-166		LX 2	Group 6	
203	PL3 3	167-178		601	Chauvet Par 5	327-336
204	PL3 4	179-190		602	Chauvet Par 6	337-346
205	PL3 5	191-202		603	Chauvet Par 7	347-356
206	PL3 6	203-214		604	Chauvet Par 8	357-366
Advance	Group 8			LX 3	Group 7	
801	Robe Robin DLS profile L	2/001		701	Chauvet Par 9	367-376
802	Robe R	2/048		702	Chauvet Par 10	377-386
Booms	Group 9			703	Chauvet Par 11	387-396
901	Lanta Fireball TRI RGB Par	443-447		704	Chauvet Par 12	397-406
902	Lanta LED par	448-452		Cyc	Group 12	
903	Lanta led Par	453-457		121	Chauvet Color-Dash Batten Quad 12 - 1	407-412
904	Lanta LED Par	458-462		122	Chauvet Batten 2	413-418
905	Lanta LED Par	463-467		123	Chauvet Batten 3	419-424
906	Lanta LED Par	468-472		124	Chauvet Batten 4	425-430
907	Lanta LED Par	473-477		125	Chauvet Batten 5	431-436
908	Lanta LED Par	478-482		126	Chauvet Batten 6	437-442
	Spare PL3			127	Chauvet Batten 7	2/
112	PL3 13	483-494		128	Chauvet Batten 8	2/
113	PL3 14	495-506				

The Electric Theatre Technical Specifications

1.	Audience Capacity	Balcony, bleacher and orchestra pit (as seating)	210
		with orchestra pit in use / covered	180
	Steward/Usher Seats	Maximum of	3
	Wheelchair spaces	Some seats in the front row of the bleacher units (row C) may be removed for up to six wheelchair users (one wheelchair takes out two seats.)	
2.	Auditorium	Normal use of Theatre is as a single tier of seats facing a proscenium arch formed by folding doors and an adjustable height pelmet. With the seating retracted and proscenium doors folded back a flat floor hall is formed.	
		Fixed stage edge to balcony front	11.80m
		Fixed stage edge to back wall	10.10m
		Clear length of flat floor 'hall', inc. stage	21.90m
		Width between walls	12.20m
		Width between proscenium doors folded out	10.90m
		Height-floor to side ceiling	9.30m
3.	Orchestra Pit	Front two rows retract under fixed floor to provide facilities for an orchestra pit.	
		Orchestra pit - total area	14.40m.sq
		Orchestra rail to stage edge	1.80m
		Max depth of pit below stage	1.40m
4.	Stage Proscenium:	width with doors set in	7.20m
		width with doors out	10.90m
		height (structural)	6.00m
		height (visual) adjustable down to	4.50m
		Depth from stage edge:	
		to upstage entrance lobby	9.00m
		to back wall	10.40m
		Width between stage walls	12.20m
		height - bar flying downstage	8.10m
		bar flying upstage	4.30m
		Overall area	118m.sq
		Advance and LX1 bars on electric chain hoists, Capacity	250kg
		Flying adjustable pelmet on hand winch	
		31 handline sets, capacity (Cinema screen dead hung on bar 12 – not available for use.)	150kg
		9.00m	
		distance between bars	0.25m
bar length (including extensions)	9.00m		
	Rostra	11 - 2.4 x 1.2m (8x4) & 2 - 1.2 x 1.2m (4x4) Adjustable to four heights - 7",12",18",24" designed to be compatible with 'Steeldeck' staging sections	
	Floor	flat and level - tongue and groove maple, semi-sprung	

	Get-in	tailboard height in private yard into stage right wing width 2.90m height 3.00m
5.	Scene store	None
5.		
6.	Lighting	Control room in rear of auditorium above fixed balcony. Alternative position in back of stalls.
	Control system	ETC Ion 1024 channels & 2 x 20 fader wing, 2 universes
	Dimmed channels	48 @ Chilli Pro Bypass (2 x 2410i Bypass Cabinet + RCD) 3 no. Strand Act 6 dimmers (installed in rack USR).
	Projection	Christie 8000lm DLP HD projector Variety of screens for front and rear projection
	Lighting equipment	8 no. Selecon PL4 LED profiles (bridge position) RGBW 12 no. Selecon PL3 LED fresnels (advance and LX1) RGBW 12 no. Chauvet ColorDash Quad 18 LED pars RGBA (LX 1 / 2 / 3) 6 no Chauvet ColorDash Quad 12 LED battens RGBA (CYC) 6 no. Cantata 11/26 2 no. Cantata 18/32 12 no. Cantata F 14 no. Prelude F 8 no Prelude 16/30 profiles 6 no. 19 dg source 4 profiles 2 no. 25/50 source 4 zoom profiles 16 no. par 64/ CP62 parcans 8 no par 64 LED RGB parcans 6 no Par-56 MFL 6 no Coda 500/4 2 no Nocturn 500w floods 2 no 700w MSR RJ'Foxie' Followspots 2 no Robe Robin DLS moving head fixtures (Extra charge for use)
	Please note that occasionally lighting equipment is taken out of service for repair / maintenance. We cannot guarantee that all equipment is available at all times. Please check availability. This also applies to sound and effects equipment (speakers, amps, smoke, haze etc)	
	Smoke Machines	1 no Magnum 2000 smoke machine – DMX / remote control 1 no Unique hazer – DMX control (Charge for use of smoke / haze)
7.	Sound	Control position in control room or at the back of the auditorium, 32 Microphone lines (distributed DSL/DSR/USR/USL/Orchestra pit) 16 Loudspeaker lines (distributed as above) 8 amp return lines (DSL)
7.	Vocal mic -	5 x SM 58
	Instrument mic -	4 x SM 57
	Float mic -	3 x Audio Technica AT835B rifle mics 3 x Sennheiser K6/ ME67 rifle mics 2 x Crown plate mics 3 x CPC hanging mics 2 x passive Di boxes / 1x Active Di box Shure Drum Kit mic set 10 x boom mic stands 2 x short boom stands
	Mixing desk	Soundcraft Si Expression 3 – 32 channel digital desk Soundcraft Si Expression 1 - 16 channel digital desk
	Effects playback	1 x Gemini CD player 1 x Sony CD Player 1 x Sony Mini-Disc player/recorder 1 x Yamaha SPX1000 digital reverb processor 5 x QSC stereo power amplifiers 1 x Yamaha EMX 640 mixer/amplifier

	Loudspeakers	HK Contour flown array – active system with 4 x 18 inch subs. 4 x Renkus Heinz Qube Q12 300w speakers FoH 4 x Electrovoice Sx200 foldback/effects speakers 3 x Custom wedges 15 inch 2 x HK Premium PR:O active Sub 18 inch 600w 2 x HK Premium PR:O active monitors/tops 15 inch 600w
	Communications	Full facilities on SM desk includes single-channel intercom by Metro Audio, 8-station cue light system, show relay and paging system
	Radios	4 x icom 2 way radios
	Assisted listening	Sennheiser infra-red system in Auditorium Single channel Induction loop at Box Office counters
8	Backstage	
	Power availability	2 x 63a/3ph 1 x 32a/3ph 16a/1ph available on distro 13a DSL / R, USL / R
	Dressing rooms	2 on first floor fitted out, each for 8 to 12.
	Toilet and showers	ensuite to each dressing room
	Video system	Relaying stage to dressing rooms and Bar

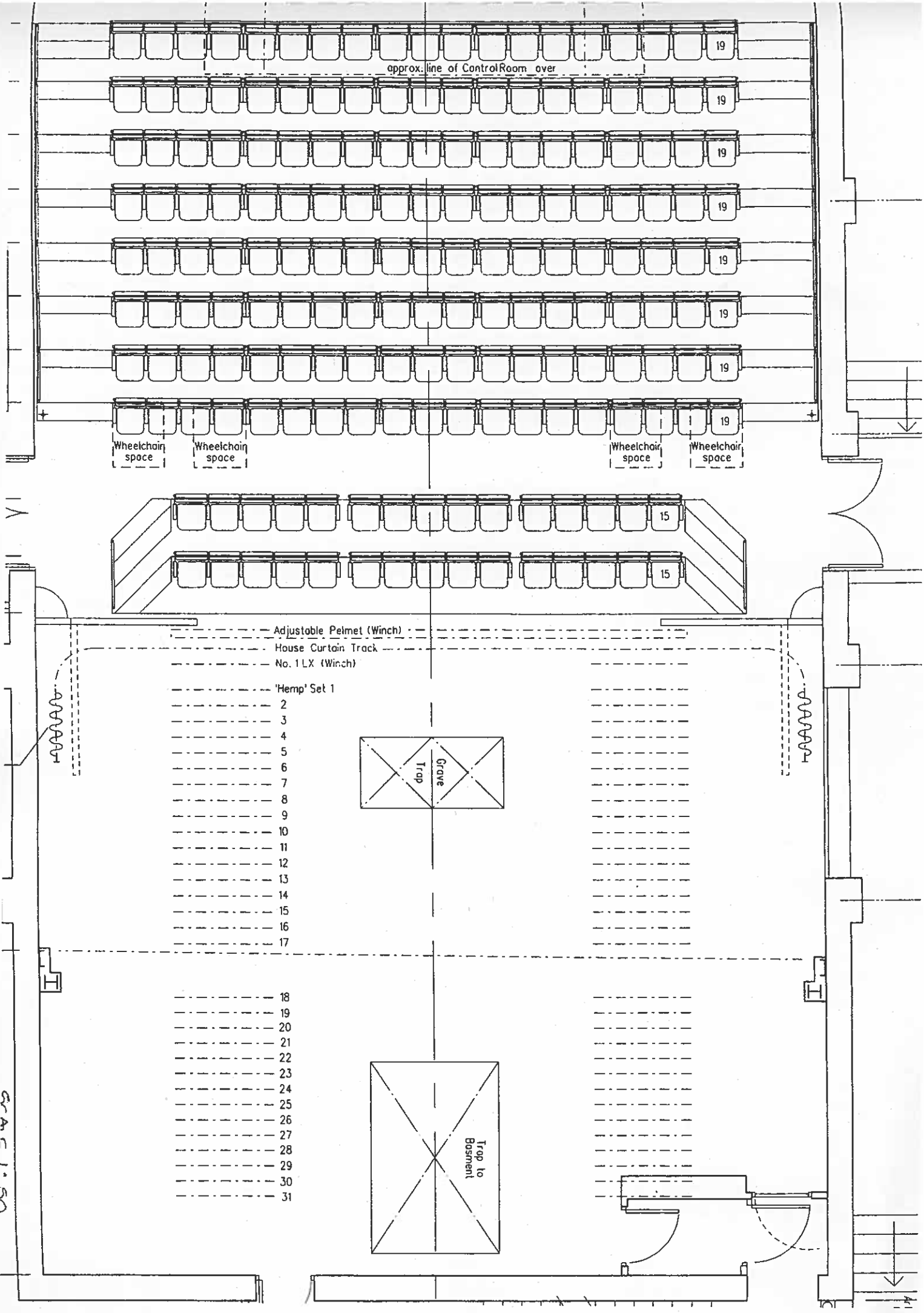

approx. line of Control Room over

19

19

19

19

19

19

19

19

Wheelchair space

Wheelchair space

Wheelchair space

Wheelchair space

15

15

Adjustable Pelmet (Winch)

House Curtain Track

No. 1 LX (Winch)

'Hemp' Set 1

- 2
- 3
- 4
- 5
- 6
- 7
- 8
- 9
- 10
- 11
- 12
- 13
- 14
- 15
- 16
- 17

Trap

Grave

Trap to
Basement

- 18
- 19
- 20
- 21
- 22
- 23
- 24
- 25
- 26
- 27
- 28
- 29
- 30
- 31

SCA C 1.0 SN

Electric Theatre Floor Plan
Auditorium Seat.

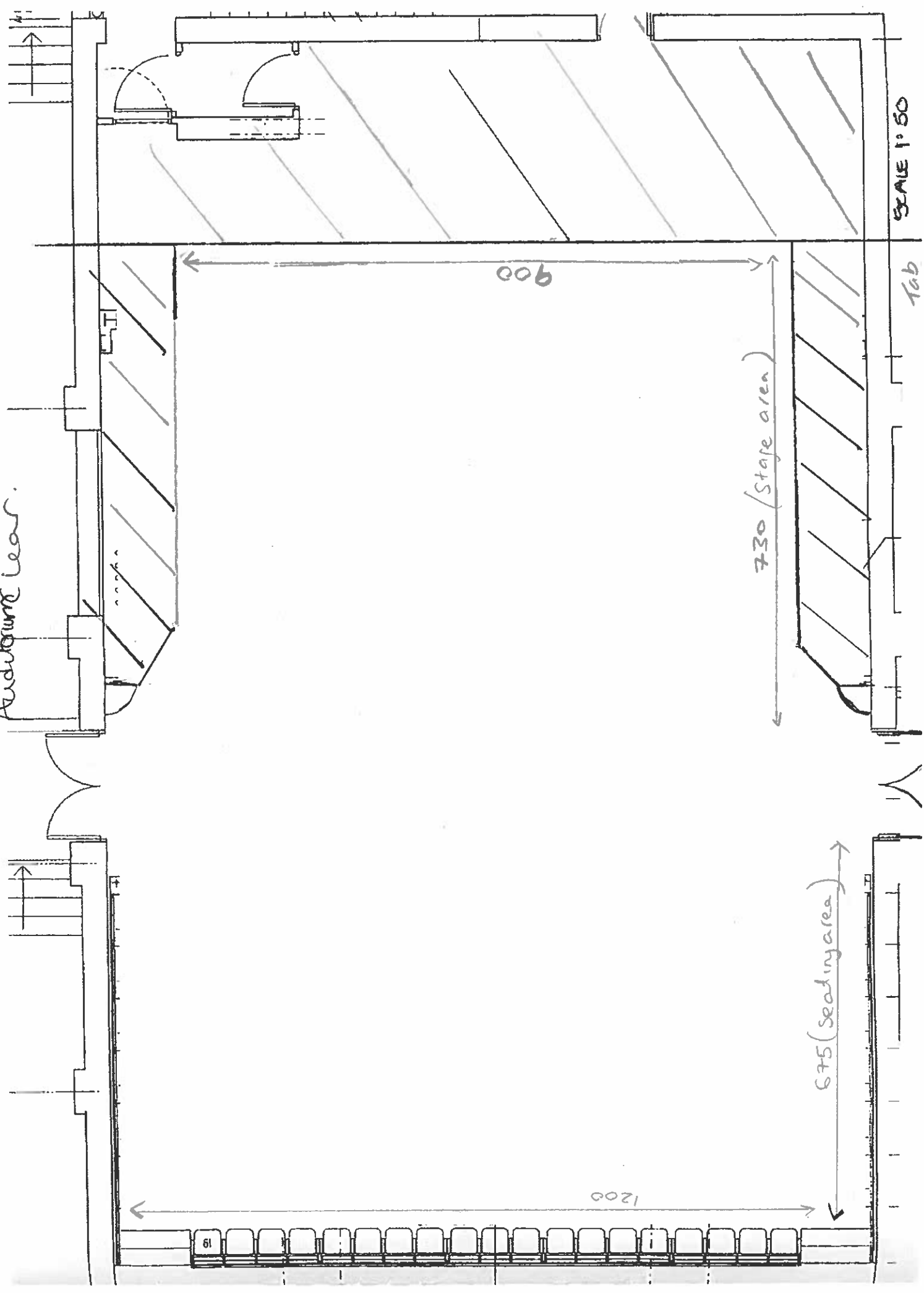

SCALE 1:50

Tab

675 (Seating area)

900

730 (Stage area)

1200

61